



## Gearmotor - GP25D-01 Series

Voltage : 12 - 36V DC  
 Rated Speed : 100 - 300rpm  
 Rated Output Power : 30 - 100W  
 Gear Ratio : 6 : 1  
 Roted Torque : 15.8 - 19.1kg-cm[13.8-16.6lb-in]  
 Motor Diameter : Ø129mm[5.08inch]  
 Typical Application : Hydraulic Pump, Water Pump

\*Gearbox is available to request

### Performance Curve

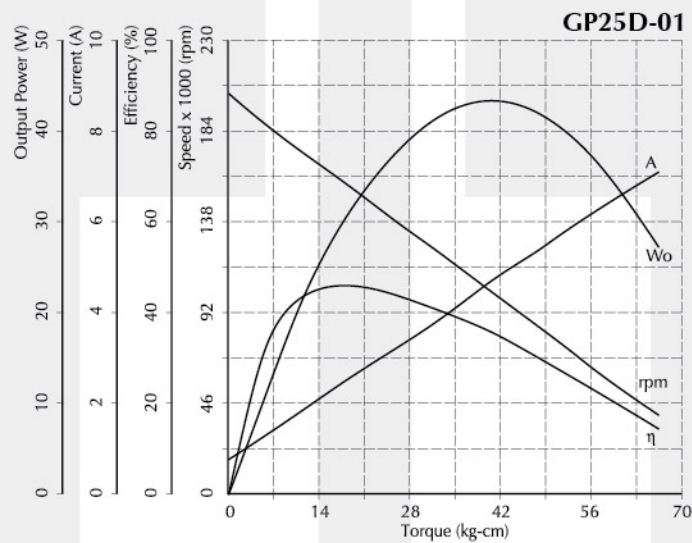

### Dimension (mm[inch])

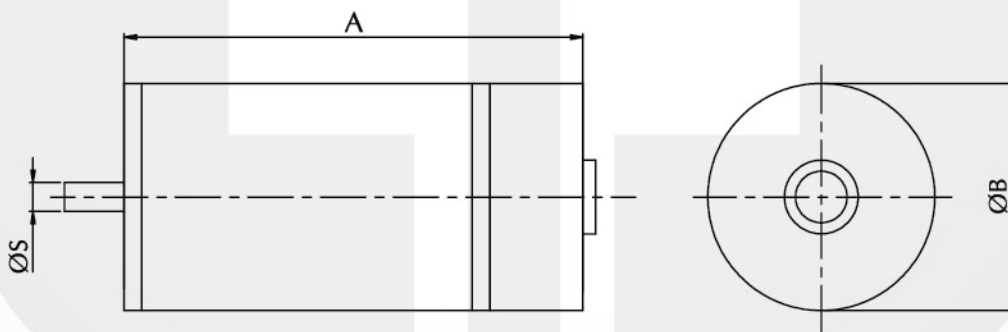

### Performance (testing under room temperature)

Model	Dim A mm[inch]	Dim B mm[inch]	Dim S mm[inch]	Gear Ratio	Rated Voltage (V DC)	No Load		At Maximum Efficiency				Max Power		
						Speed (rpm)	Current (A)	Torque (kg-cm[lb-in])	Speed (rpm)	Current (A)	Output (W)	Effic'y (%)	Torque (kg-cm[lb-in])	Current (A)
GP25D-01-01	150.0[5.90]	129.0[5.08]	64.8[2.55]	6:1	25.6	202	0.8	19.1[16.6]	156	2.6	30.5	46	41.6[36.1]	4.7
GP25D-01-02	150.0[5.90]	129.0[5.08]	64.8[2.55]	6:1	12.8	215	1.2	15.8[13.8]	168	4.1	27.3	52	36.0[31.3]	7.8

The information above is for reference only, detailed specification is subject to final confirmation

Email: sales@cclmotors.com Website: <http://www.cclmotors.com>  
 4/F, No. 6, On Lok Mun Street, On Lok Tsuen, Fanling, N.T., Hong Kong.

Tel: (852) 3125 0000 Fax: (852) 3125 0125