

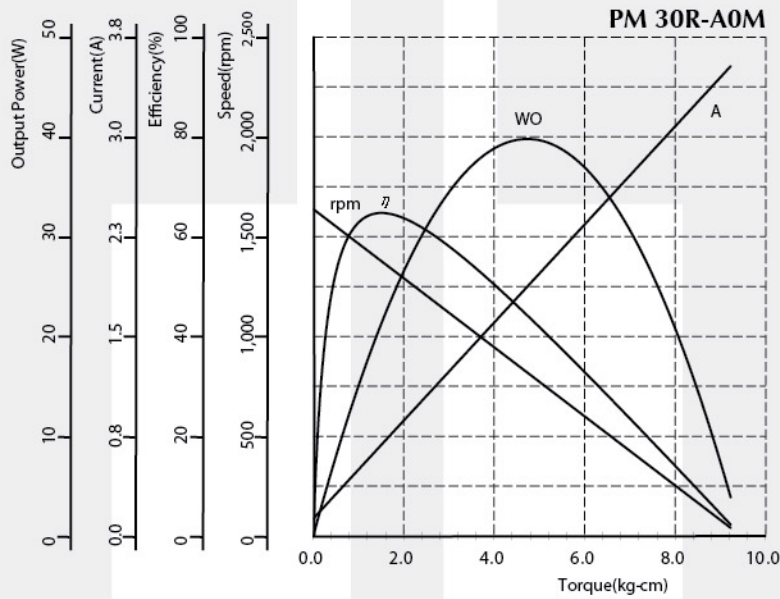

Industrial PMDC Motor - PM30R Series

Voltage : 12 - 220V DC
 Rated Speed : 1,400 - 6,000rpm
 Rated Torque : 1.47 - 8.20kg-cm[1.28 - 7.12lb-in]
 Rated Input Power : 30 - 1200W
 Insulation Class : A, E, B
 Motor Diameter : \varnothing 78.9mm[3.11 inch]
 Typical Application : Hydraulic Pump, Water Pump, Winding Machine, Stamping Machine, Door Opener, Winch, Drilling, Ice Machine, Machine, Conveyor Belt, Convertible Top, Machine Tool, Polisher

Performance Curve



Dimension (mm[inch])

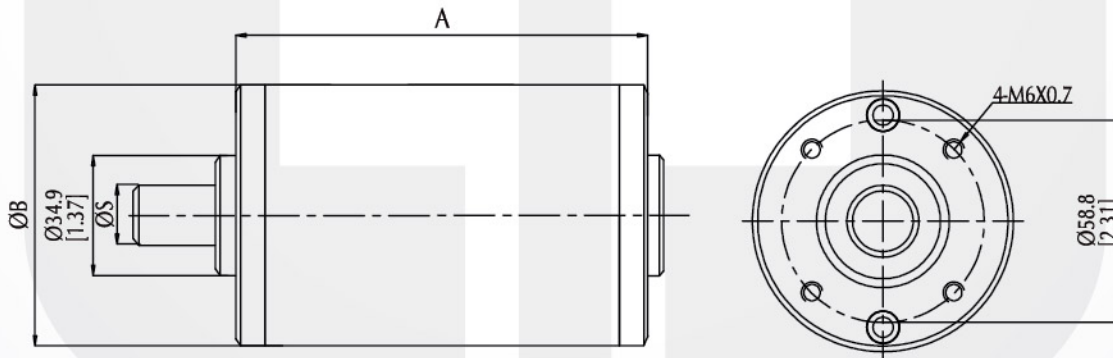

Performance (testing under room temperature)

Model	Dim A mm[inch]	Dim B mm[inch]	Dim S mm[inch]	Rated Voltage (V DC)	No Load		At Maximum Efficiency				Maximum Power			
					Speed (rpm)	Current (A)	Speed (rpm)	Current (A)	Torque (kg-cm[lb-in])	Output (W)	Speed (rpm)	Current (A)	Torque (kg-cm[lb-in])	Output (W)
PM30R-A0F	117.9[4.64]	78.9[3.11]	8.0[0.31]	12	5,496	6.8	4,757	51.06	8.20[7.12]	400	2,697	151.29	32.70[28.38]	905.7
PM30R-A0M	193.3[7.61]	78.9[3.11]	8.0[0.31]	48	1,638	0.13	1,361	0.72	1.60[1.39]	22.4	810	1.97	4.70[4.10]	39.1
PM30R-35L	135.1[5.32]	78.9[3.11]	8.0[0.31]	115	2,039	0.1	1,809	0.35	1.47[1.28]	27.3	1,052	1.1	5.20[4.51]	56.2

The information above is for reference only, detailed specification is subject to final confirmation