

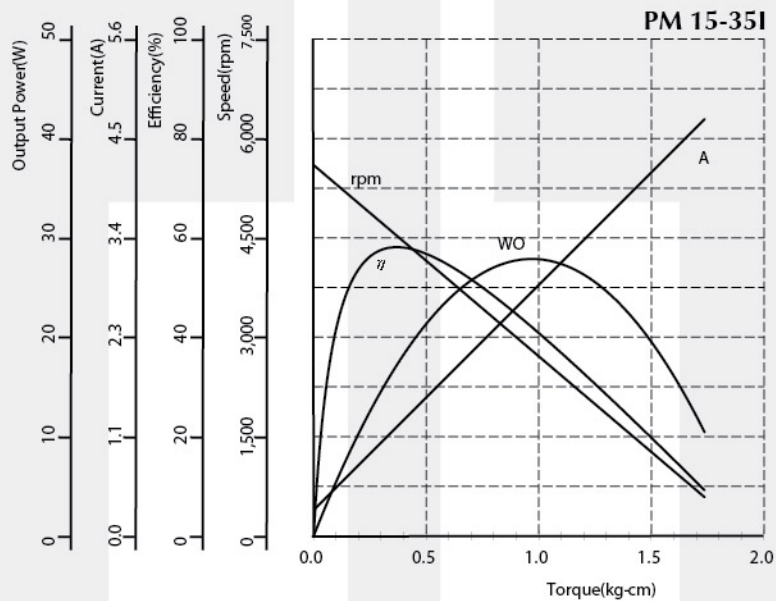

Industrial PMDC Motor - PM15R Series

Voltage : 12 - 48V DC
 Rated Speed : 4,300 - 7,200rpm
 Rated Torque : 0.20 - 0.38kg-cm[0.20 - 0.33lb-in]
 Rated Input Power : 14 - 120W
 Insulation Class : A, E, B
 Motor Diameter : \varnothing 40.4mm[1.59inch]
 Typical Application : Air/Water Pump, Stamping Machine

Performance Curve



Dimension (mm[inch])

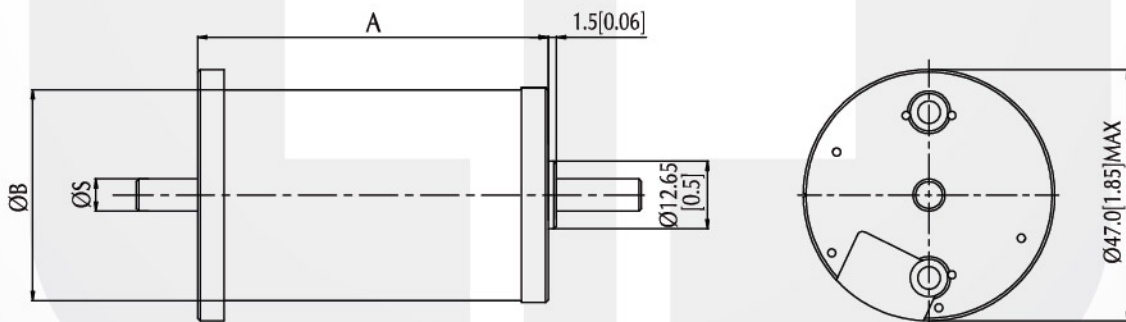

Performance (testing under room temperature)

Model	Dim A mm[inch]	Dim B mm[inch]	Dim S mm[inch]	Rated Voltage (V DC)	No Load		At Maximum Efficiency				Maximum Power			
					Speed (rpm)	Current (A)	Speed (rpm)	Current (A)	Torque (kg-cm[lb-in])	Output (W)	Speed (rpm)	Current (A)	Torque (kg-cm[lb-in])	Output (W)
PM15R-35I	100.4[3.95]	40.4[1.59]	6.0[0.24]	24	5,600	0.29	4,502	1.26	0.38[0.33]	17.6	2,800	2.8	1.00[0.87]	27.9
PM15R-24M	65.60[2.56]	40.4[1.59]	6.0[0.24]	48	6,106	0.1	4,996	0.48	0.29[0.25]	14.88	3,004	1.17	0.80[0.69]	24.7
PM15R-21F	86.00[3.39]	40.4[1.59]	6.0[0.24]	12	5,107	0.3	4,171	1.36	0.20[0.20]	8.6	2,575	3.05	0.59[0.51]	15.6
PM15R-24I	65.60[2.58]	40.4[1.59]	6.0[0.24]	24	5,500	0.3	4,483	0.8	0.26[0.23]	12.0	2,696	1.91	0.71[0.62]	19.66

The information above is for reference only, detailed specification is subject to final confirmation

Email: sales@cclmotors.com Website: <http://www.cclmotors.com>
4/F, No. 6, On Lok Mun Street, On Lok Tsuen, Fanling, N.T., Hong Kong.

Tel: (852) 3125 0000 Fax: (852) 3125 0125