



Low Voltage PMDC Motor-DB Series

Voltage : 3 - 36V DC
 Rated Speed : 3,000 - 20,000 rpm
 Rated Input Power : 20~90W
 Insulation Class : A, B

Typical Applications : Water Pump, Air Pump, Fan, Hair Dryer,
 Paper Shredder, Power Brush, Vacuum Cleaner, Vending Machine

Performance Curve

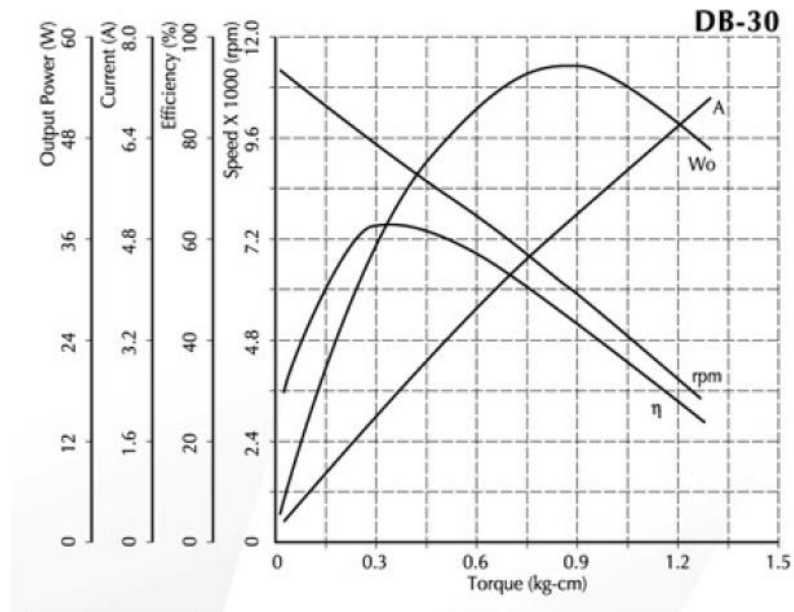

Dimension(mm[Inch])

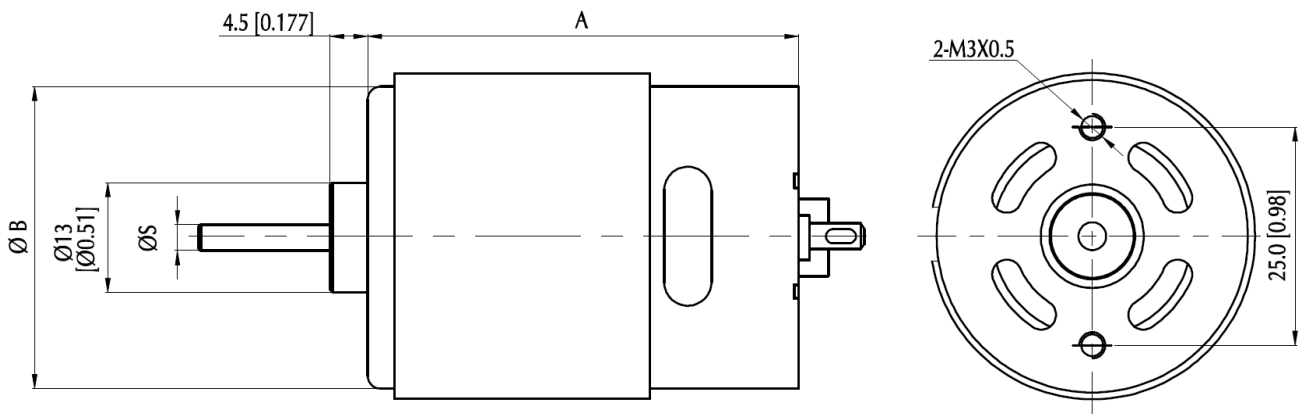

Performance(Testing under room temperature):

Model	Dim A mm [Inch]	Dim B mm [Inch]	Dim S mm [Inch]	Rated Voltage (V)	No Load		At Maximum Efficiency				Maximum Power			
					Speed (rpm)	Current (A)	Speed (rpm)	Current (A)	Torque (kg-cm[lb-in])	Output (W)	Speed (rpm)	Current (A)	Torque (kg-cm[lb-in])	Output (W)
DB-20	50 [1.97]	35.8 [1.41]	3.175 [0.125]	12	15,700	0.7	13,700	5.5	0.30 [0.26]	10	7,500	2.5	0.70 [0.61]	
DB-30	57 [2.24]				6,450	0.4	5,430	2.05	3.30 [2.87]	50	3,200	2.0	0.80 [0.70]	

The information above is for reference only, detailed specification is subject to final confirmation